

Keelin[®]

Guardian Angel



GPT18 Quick Start Guide



NOTICE

- ① A Nano SIM Card needed, do not support CDMA2000;
Please use original Nano SIM card provided by operator, do not use card made by card cutter or it will harm watch.



SIM



Micro SIM



Nano SIM



- ② GPRS & Call ID of Sim Card must be opened;
Traffic, SMS, Calls and other SIM card service fee charged by operators;
- ③ Positioning / Remote Power off / Remote command function rely on the network of base station. Device may not work well if the network signal is not very good;
- ④ Product should stay away from fire, high temperature, heat and other extreme environments;
- ⑤ Product should not be long time soaked or rinsed in water;

INTRODUCTION

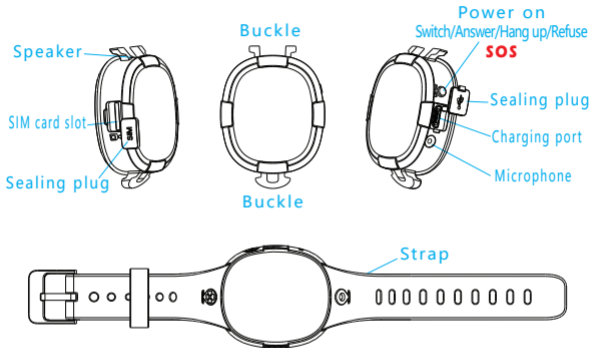

- **Power On** : Press >3s to power on (No power off button, use app to power off)
- **Switch/Answer/Hang up/Refuse** : If there is an incoming call from guardian number which can be set on app (Call form non-guardian will be rejected) , short press to get through and long press to reject, It will get through automatically in 40s if no answer. Short press to hang up.
- **SOS**: Press >3s to call guardian number and send SOS alarm to web platform and APP.

FUNCTION/PARAMETER

- Application to elder, kids, It's born for guarding.
- High Accurate Satellite Positioning System
(GPS & BDS or GLONASS), also support WiFi / LBS positioning.
- One key for SOS help to three guardian number.
- Phone from guardian number will get through automatically in 40 seconds if there is no initiative answer.
- Silicone Strap, IP65 Waterproof Level.
- Listening watch.
- APP tracking & Play back history route of watch
- APP receive watch SOS alarm, fence alarm, low power alarm
- APP view pedometer steps & exercise.

Satellite Positioning Accuracy	5-15m (Depend Satellite signal)
LBS Positioning Accuracy	About 200m (Depend Bases Density)
WiFi Positioning Accuracy	5-50m (Depend Hot Spots Density)
GPS Frequency Band	1575 MHz
GSM Frequency Band	850/900/1800/1900 MHz
Hot/Warm/Cold Start Time	<3s, <15s, <60s
Battery Capacity	470 mAh
Dimensions (mm)	40(L)×35(W)×14.8(H)
Temperature/Humidity	-20°C~65°C / 20%~80%RH
Weight	40 g

Q & A

Q: Positioned by Satellite / WiFi / LBS ?

A: Satellite positioning means GPS/BDS/GLONASS etc Satellite Positioning System
Device can be positioned by satellite outdoor. Device with Wifi module positioned by WiFi hot spot nearby for indoor positioning. Device also can be positioned by base station of operator which call LBS, mainly for assistance positioning.

Q: Location is not accurate?

A: If need accurate positioning, use device outdoor where Satellite signal is good and start Satellite tracking mode.
Device indoor mainly positioned by LBS & WiFi, the accuracy lower than GPS

Q: Standby time can be longer?

A: Device need Internet connection. Standby time will be different by different using environment and working mode.

Q: Device offline?

A: The conditions below results in offline.

- ① No balance or No SIM
- ② No GSM or GSM signal is weak
- ③ Battery runs out

1

Remove strap, insert SIM card, charge & boot

- Complete Accessories include Strap, Module, USB cable, Manual.



- Hold back of watch, gently press strap at bottom side with symbol ▼, make module separated, insert Nano SIM and close sealing plug

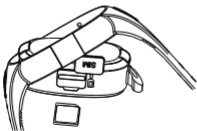

- Connect USB cable, fully charged and put back module to strap.

▶▶ Begin experience of Watch Tracker

2

Install KEELIN APP, Activate device

- Scan QR below to download Keelin APP



- Launch APP , Scan QR on Label to register & activate device



▶▶ Begin experience of Keelin APP

*e²***Link** Watch Tracker for Kid & Elder

EELINK Communication Technology CO.LTD

Address: 3 Floor, Yu yang mansion, Gaoxin North 4th Rd, Keji North 2nd Street,
Science and Technology Park, Nanshan District, ShenZhen, CHINA

TEL : +86 0755 86278376 / 86278370

Mail : Sales@eelink.com.cn